

THE CITY OF NAPOLEON

BUILDING & ZONING DEPARTMENT

255 W. RIVERVIEW

(419)592-4010

Building Permit

Permit Number: BP2007-91

Page 1 of 1

Printed: 6/19/2007

ADDRESS:

538 Washington St. W.

Applicant

Name: Mock Buehrer Builders

Address: P-707 Co. Rd. 16

Approval Date: 6/4/2007

419-592-0825

Owners

Name: Mr. Earl George

Address: 538 W Washington St.

Napoleon, OH 43545

Contractors

Contractor Type: GENERAL CONTRACTOR

Name: Mock Buehrer Builders

Napoleon, OH 43545

Address: P-707 Co. Rd. 16

Phone: 419-592-0825

Fees and Receipts:

Number	Description	Amount
FEE2007-312	Reroofing/Siding/Gutters (Auto	\$40.00
FEE2007-313	State 1% fee (Calc)	\$0.40
Total Fees:		\$40.40
RCPT2007-296		\$40.40
Total Receipts:		\$40.40

re roofing

APPLICANTS SIGNATURE: _____

DATE: JUN 19 2007

REMINDER: YOU MUST CALL (419)592-4010 FOR AN INSPECTION

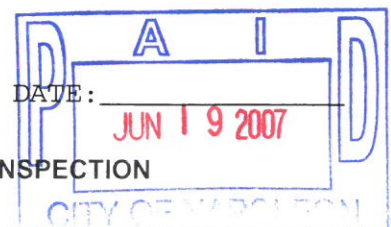

BP07-91

40⁴⁰ Due OK

CITY OF NAPOLEON GENERAL PERMIT APPLICATION

THIS APPLICATION IS FOR RESIDENTAL CONSTRUCTION INCLUDING BUILDING, ELECTRICAL, PLUMBING, MECHANICAL, DEMOLITIONS, REMODELING.

DATE: 6-4-07 JOB LOCATION: 538 W. WASHINGTON

OWNER: EAL GEORGE PHONE: _____

OWNER ADDRESS: SAME CITY: WAP ZIP: _____

CONTRACTOR: MOCK-BUEHRER

PHONE #: _____ CELL PHONE#: 392-6189

CONTRACTOR LICENSED WITH THE CITY OF NAPOLEON?: YES NO:

Is any of the above job going to be subcontracted out? Yes No:

If yes to whom: _____

DESCRIPTION OF WORK TO BE PERFORMED: _____

ESTIMATED COMPLETION DATE: _____

PLEASE MARK THE TYPE OF WORK YOU WILL BE PERFORMING

- | | |
|--|---|
| <input type="checkbox"/> A/C ADD ON 1% | <input type="checkbox"/> REMODELING 1% |
| <input type="checkbox"/> BOILER REPLACEMENT 1% | <input checked="" type="checkbox"/> ROOFING 1% |
| <input type="checkbox"/> CURBING | <input type="checkbox"/> SEWER REPAIRS** |
| <input type="checkbox"/> DECKS * 1% | <input type="checkbox"/> SIDEWALK* |
| <input type="checkbox"/> DRIVEWAY* | <input type="checkbox"/> SIDING 1% |
| <input type="checkbox"/> ELECTRICAL SERVICE UPGRADE 1% | <input type="checkbox"/> SHED* (under 200 sq ft) |
| <input type="checkbox"/> ELECTRICAL SERVICE NEW 1% | <input type="checkbox"/> SHED* (over 200 sqft) 1% |
| <input type="checkbox"/> SWIMMING POOL* 1% | <input type="checkbox"/> FENCE* |
| <input type="checkbox"/> FURNACE REPLACEMENT 1% | <input type="checkbox"/> TEMP ELECTRIC 1% |
| <input type="checkbox"/> ADDITIONS* 1% | <input type="checkbox"/> FURNACE NEW 1% |
| <input type="checkbox"/> WATER TAP (size _____") | <input type="checkbox"/> WINDOWS /DOORS 1% |
| <input type="checkbox"/> LAWN METER 1% | |
| <input type="checkbox"/> PLUMBING 1% | |

1%- EFFECTIVE JUNE 1, 2007 BOARD OF BUILDING STANDARDS FEE

*PLEASE INCLUDE A PICTURE SHOWING MEASUREMENTS FROM EXISTING STRUCTURES AND PROPERTY LINES. INDICATING THE TYPE OF WORK YOU WISH TO PERFORM.

** IF WORK REQUIRES GOING INTO THE STREET A STREET BOND IS REQUIRED!

FOR PERMIT COSTS PLEASE FILL OUT REVERSE SIDE.

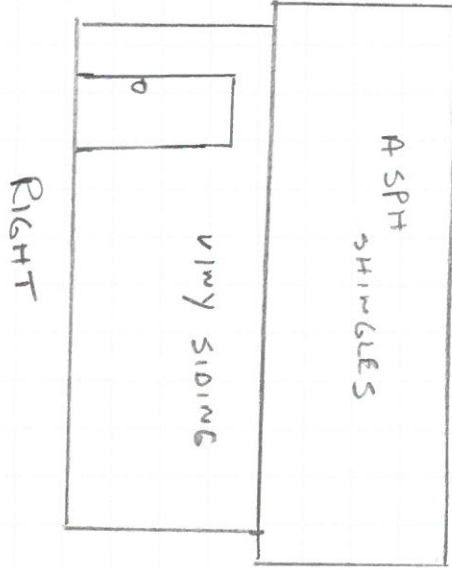
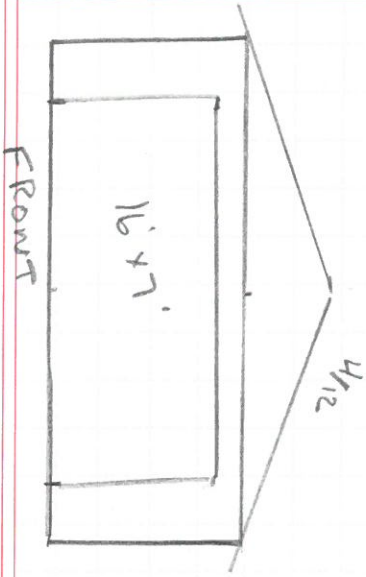

21 x 21

EARL GEORGE

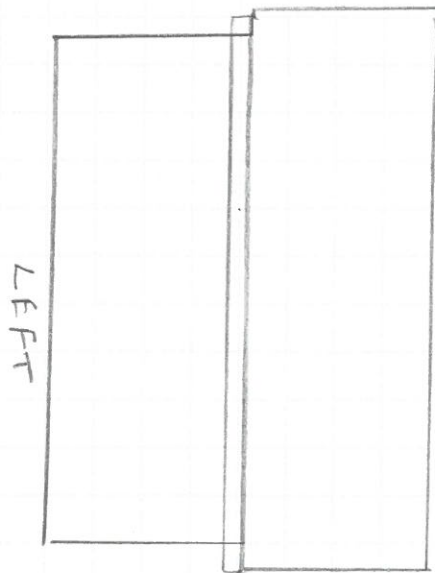

4280 EAST ROAD
LIMA, OHIO 45807
(419) 331-4015
WATS 1-800-783-5005
FAX (419) 331-2202



RN BUILDING MATERIALS

711 HADLEY DR.
COLUMBUS, OHIO 43228
(614) 272-5577
WATS 1-800-370-9470
FAX (614) 272-6815